

# Spring

# HOME

## IMPROVEMENT 2



- Soak up these luxurious bathroom features
- Why hiring a painter is the right choice
- Tech upgrades for your home entertainment space

## 14'x32' Classic Garage

Only **\$11,250**

OR

**Rent-To-Own**  
**\$520<sup>83</sup>** /mo. for 36 months



## 10'x14' High Barn

Only **\$3,750**

OR

**Rent-To-Own**  
**\$173<sup>61</sup>** /mo. for 36 months



## 8'x10' Cottage

Only **\$2,562**

OR

**Rent-To-Own**  
**\$118<sup>61</sup>** /mo. for 36 months



**FREE Delivery**  
within 40 miles

*Compare our  
quality and  
pricing, we  
think you'll be  
glad you did!*

**Yoder's QUALITY SHEDS**

**278 ATSWELL RD., RICHFIELD SPRINGS • 315-858-0841**  
**MON-FRI 8 AM - 4 PM • SAT. BY APPOINTMENT • CLOSED SUNDAY**

# Tech upgrades for your home entertainment space

Life in the twenty-first century can feel like it's moving at breakneck speed. Perhaps nowhere is that feeling more pronounced than within the technology sector, where new products are often upstaged by more advanced models, sometimes within a few weeks of an item's initial release.

The speed with which technology advances can make it difficult to keep up. However, it's important to note that software updates can bring devices up to speed in a matter of minutes, often at no cost to users. That can quiet concerns some may have about investing in entertainment room technology. For those ready to move forward with their entertainment room remodel, these tech upgrades can take such spaces to the next level.

- **New television:** Consumers who like to watch television but are not necessarily into what makes certain televisions more suitable to their viewing habits than others may find their heads spinning when they begin their search for a new device. Indeed, the alphabet soup of OLED, QLED, 4K, and other television styles can be difficult to navigate. If confusion reins over your television shopping trips, it might help to identify what you watch most often and then find the type of TV that most suits your viewing habits. Though opinions vary and consumers should always trust their own eyes, the United Kingdom-based Smart Home Sounds recommends OLED televisions for movie and television lovers as well as gamers who require fast response times. Sports fans may benefit by prioritizing refresh rate when shopping for a new television. Though refresh rate is not the only variable to consider, a faster refresh rate can ensure games don't look fuzzy when the action picks up.

- **Speaker system:** Surround sound can take any entertainment setup to the next level. Modern televisions are slim and that sleek design does not always translate to great built-in sound. Though some recent models



**Kubota**  
**ORANGE DAYS**  
SALES EVENT

**COMPACT TRACTORS**

**0%** APR | UP TO **84<sup>MOS</sup>**

— OR —

SAVE UP TO **\$3,500\***

ON BX23S KUBOTA EQUIPMENT



KubotaUSA.com



\*\*Based on EDA tractor sales data of under 40 horsepower models from 2018 to 2022. © Kubota Tractor Corporation, 2025. \$0 Down, 0% A.P.R. financing for up to 84 months on purchases of new select Kubota BX23s series equipment from participating dealers' in-stock inventory is available to qualified purchasers through Kubota Credit Corporation, U.S.A.; subject to credit approval. Example: 84 monthly payments of \$11.90 per \$1000 financed. Customer instant rebates include Orange Plus Attachment Instant Rebate of \$200 with purchase of third qualifying new implement and \$200 for the fourth new qualifying implement. There is no rebate on the first and second implement purchased. Offers expire 6/30/25. Terms subject to change. This material is for descriptive purposes only. Kubota disclaims all representations and warranties, express or implied, or any liability from the use of this material. For complete warranty, disclaimer, safety, incentive offer and product information, consult your Dealer or KubotaUSA.com.

**WHITE'S**  
**FARM SUPPLY, INC.**

**Sat., April 26 | 9am - 2pm**

**WATERVILLE**  
962 Route 12  
315-841-4181

**Sat., May 3 | 9am - 2pm**

**LOWVILLE**  
8207 Route 26  
315-376-0300

**Fri., May 9 | 12pm - 7pm**

**CANASTOTA**  
4154 Route 31  
315-697-2214

**WhitesFarmSupply.com**

feature dramatically improved built-in sound capabilities compared to their slim screen ancestors, a home theater system featuring superior sound is still a must. A home theater surround sound system with subwoofer and Bluetooth connectivity can



greatly improve the viewing experience no matter what's on-screen. For consumers working on a tight budget, a soundbar that can be upgraded with additional surround sound speakers down the road can be a great way to slowly build a theater-like sound system in your living room. When purchasing a surround sound system, consumers also can consider speaker stands that hold larger rear speakers in place.

• **Lighting:** Entertainment room lighting can be easy to overlook, particularly when consumers go down the television and sound system rabbit holes. But the right lighting can set the perfect tone in an entertainment room. The decision of which lighting to go with should include consideration of how the space will (or won't) be used when you aren't watching the latest blockbuster or big game. If the room is exclusively for movies or big games, then lighting that calls to mind a movie theater, complete with LED strip lights on the walls, is an option worth considering. If the entertaining space is your living room and a space where you're just as likely to read a book as enjoy a family movie night, then recessed lighting in the ceiling with dimmable bulbs allows you to pivot back and forth between lighting schemes depending on how the room is being used at any given moment.

It's easy to get lost when considering tech upgrades for an entertainment room. But pairing the right television with great sound and appropriate lighting can make for a consistently impressive viewing experience. HI254740



**Don't Buy a Pole Barn Package Until You've Contacted Us!**  
We Offer Competitive Pricing and Guarantee Satisfaction.

## POLE BARN PACKAGE



**24' X 32' X 10' POST FRAME PACKAGE:**

*Designed to meet Your Needs*



**SHEDS AVAILABLE NOW!**

**Call Today for Your FREE Quote!**

**Call for current pricing**

**MATERIAL PACKAGE**

- Pre-Engineered Wood Trusses (6/12 Pitch, 4' O/C)
- 4.125 x 5.187 Structural Glulam 3 Ply Eave Posts (8' O/C)
- 4.125 x 5.187 Structural Glulam 3 Ply Gable Posts (10' O/C)
- 2 x 8 Treated Skirt Boards (1 Row)
- 2 x 4 Wall Girts (24" O/C) and Roof Purlins (24" O/C)
- 2 x 10 Double Top Girt Truss Carrier
- 1/4" M W I Dbl. Bubbl. Dbl. Foil Temp Shield Insulation on Roof
- Beige Everlast II Traditional Steel Siding
- Ivy Everlast II Traditional Steel Roof
- One Bag of Concrete Mix Per Post Hole

**DOORS & WINDOWS**

- Two Clopay 9 x 8 4300 Series Ins. Overhead Door Ins. Stds
- One 3' 9 Lite Entry Door

**12" OVERHANG ON ALL SIDES W/ VENTED ALUM. SOFFIT**

**FASTENERS**

- 1 1/2 Inch Screw for Steel Wall, Roof Panels
- 5 In. Ledger Lock Screw for Truss Carrier
- 3 1/2 In. Galv. Pole Barn Nails for Skirt Board
- Galvanized Steel Framing Nails

**DETAILED BUILDING PLANS**



2726 State Hwy. 7, Bainbridge, NY  
(Located Between Rte. 8, Sidney and Bainbridge, NY)  
**607-967-4877**  
www.metalroofingandmetalsiding.com

# Now Selling Cabinets

Let Our Designer Create A Cabinet Layout For You



- CABINETS
- SINKS & FAUCETS
- COUNTERTOPS
- FLOORING
- TILE

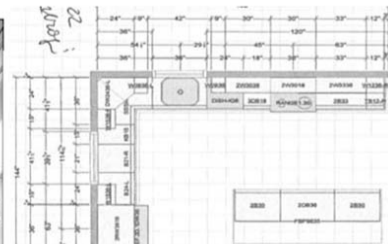

## COUNTERFITTERS LLC

**Your One-Stop Kitchen Dream Shop!**

2319 State Highway Route 20  
Carlisle, NY  
**(518) 833-2740**

Facebook@WarrenCounterfitters • Counterfittersandmore@gmail.com

# LANDSCAPE STONE FOR SALE

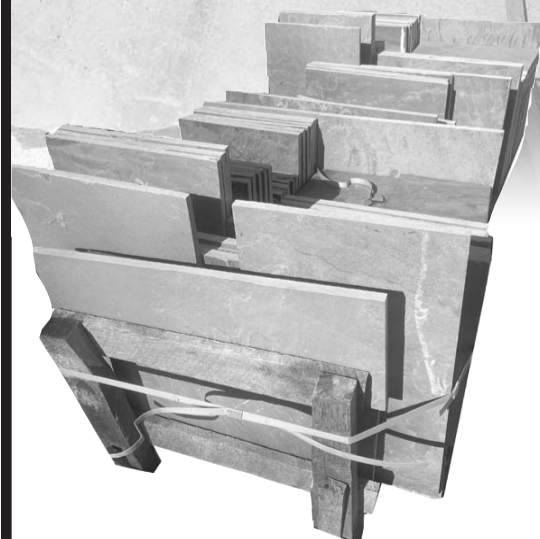

All types of wallstone, fieldstone, patio stone & boulders

## Papasidero Stone Supply

5091 State Highway 12, Norwich, NY  
**516-410-1078**

## UPGRADE YOUR HOME WITH EXPERT WINDOW & DOOR REPLACEMENT!



- Sales & Installation
- Durable, Energy-Efficient Products
- Honest Pricing - NO Gimmicks

*Transform your home today!*

Contact us for a **FREE Estimate**



# Bright-View

Windows & Doors

**QUALITY YOU CAN TRUST, PRICES YOU CAN AFFORD!**  
**607-371-0665**

# Why hiring a painter is the right choice

Few home improvements can change the look of a room faster and more affordably than a painting makeover. In fact, homeowners often turn to paint before they make any other renovations. Home Light, a real estate technology company, says painting a home's interior can net a return on investment as high as 107 percent.

Although painting is a project that can be tackled by do-it-yourselfers, there are various advantages to calling in a professional to handle painting projects. Here is a look at some of the benefits to working with a professional painter.

### Cut down on the job time

A professional painter can reduce the project timeline. Painters have the skill set and experience to complete a project in a timely manner. This means the job will be streamlined from preparation to clean-up.

### Pay attention to details

Professional painters are likely to do a job that is nearly flawless, especially after homeowners exercise their due diligence and vet painters carefully. Professionals will pay attention to the small details that less experienced painters wouldn't think about.

### Reduce your workload

Painting can be a time-consuming job, and most of it occurs even before you pick up a brush. It can take hours to prep walls, patch holes, remove moldings, and apply painter's tape. Homeowners who do not have much time are better off leaving trusting the project to a professional.

### Painters already have equipment

Do-it-yourselfers may need to buy new tools before beginning the job.

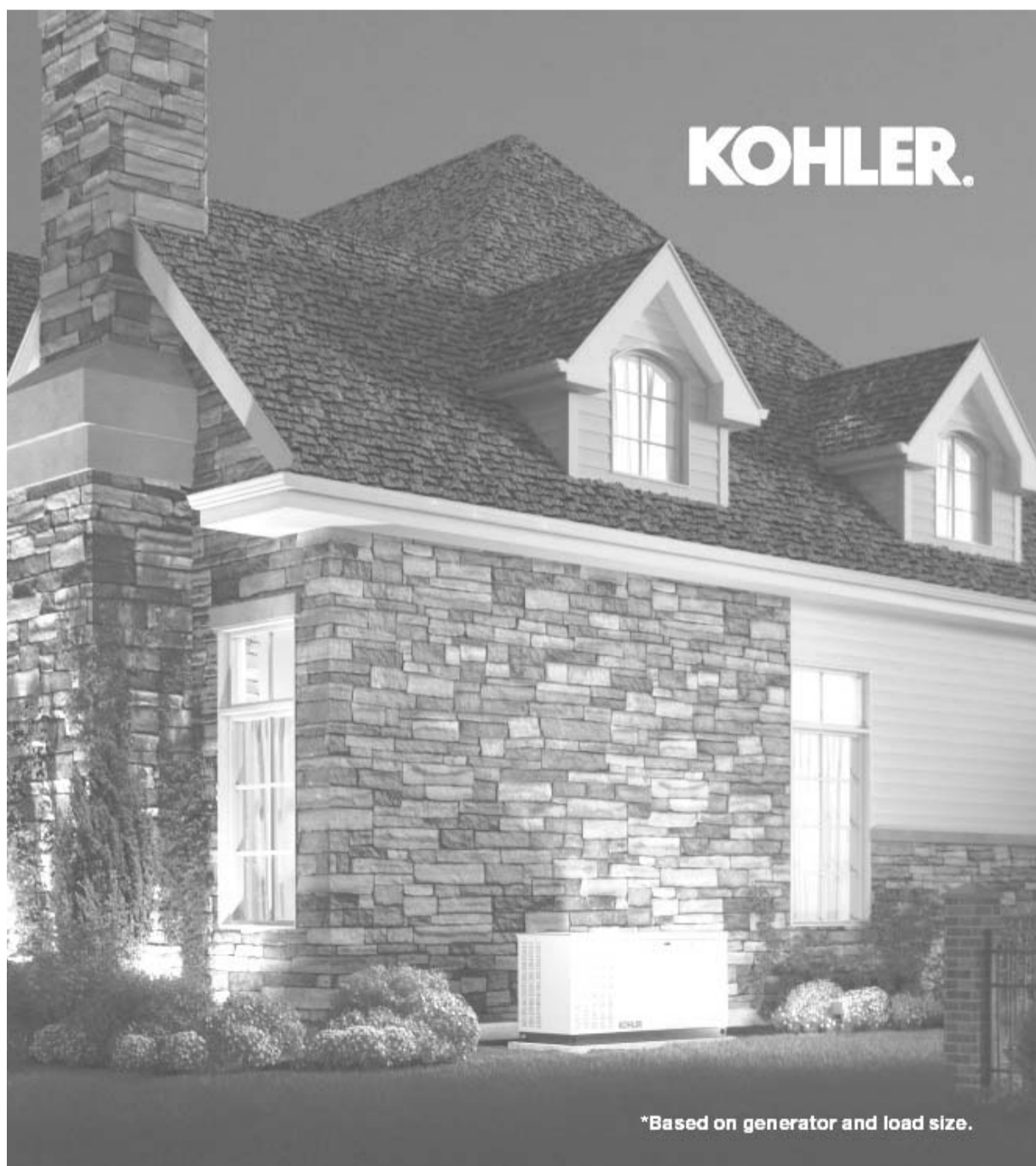

\*Based on generator and load size.

## KEEP YOUR POWER ON, EVEN WHEN THE POWER'S OUT.

Whenever there's an outage, KOHLER® generators keep your lights on, your fridge cold and your house cozy. And they can power your entire home.\* No matter the weather, we're with you.

**From engines to generators, we give the world power.**

# AVOLIO

— BROTHERS, LLC —  
Plumbing • Heating • Air Conditioning

Commercial | Residential | Industrial  
Custom Duct Fabrication

## 607-336-5572

6053 Co. Rd. 32, Norwich, NY 13815  
www.avoliobrothers.com  
brothers@centralny.twcbc.com



This means brushes, rollers, tape, tarps, trays, and much more. Unless you plan to paint multiple times, this can make stocking up a considerable investment. Professionals already have all the right gear and tools of the trade.

**Lasting results**

Professional painters understand which products will produce the desired results, depending on the wear and tear of the space. Paints are not all created equal, and certain walls, floors and trim may require unique priming and preparation that novices are not familiar with. Professional painters can help ensure durability and save homeowners from having to do the job again in a few months or years.

**A safer experience**

Painting can be a challenging job when it involves painting hard-to-reach spaces and/or climbing and balancing on tall ladders. Homeowners are not at risk of injury when hiring a professional painter. In addition, professional painters should be licensed and insured. This means if an injury or incident occurs, the homeowner will not be on the hook for the cost. A fresh coat of paint can produce amazing results. Leaving the work to a professional can ensure a job is done correctly and beautifully and completed on time. HI254741

## OUR BEST IN THE FIELD DEALS ARE HERE

For a limited time, save big on the all-new 1100 and 2100 Series. With a reliable diesel engine, our best-ever lift capacity, and intuitive tech like Crank Assist, dual-pedal HST, and a handy companion app, they're tougher and smarter than anything else out there.

**BEST  
IN THE  
FIELD  
DEALS**

**1100/2100 SERIES**

**0% APR 84<sup>MO</sup> + \$2,000 CASH BACK**

OR UP TO \$5,000 CASH BACK

**NORWICH  
OUTDOOR POWER EQUIPMENT**  
5876 County Rd. 32- East River Road, Norwich  
607-334-4378  
www.norwichope.com  
8:00-5:00 Monday-Friday and 8:00-12:00 on Saturday

**mahindra  
TRACTORS**

**OUTWORKING  
THE FIELD**

Available 0% APR financing on purchases of selected new Mahindra tractor models from participating dealers' inventory on qualified purchases through Mahindra Finance US LLC. A down-payment may be required for selected tractor models. Financing information is made available by Mahindra Finance USA LLC for discussion purposes only and is not a commitment to finance any transaction. The information provided is not intended and should not be construed as legal, accounting, or tax advice. All financing is subject to credit review and approval and other terms and conditions and is at Mahindra Finance USA LLC's sole discretion. Offer available for a limited time only and subject to change without notice.

# RANDY & BRENDA'S

## Septic Pumping and Septic Installation

*Servicing Otsego County and the surrounding areas.*

[www.randyandbrendas.com](http://www.randyandbrendas.com)

# 607-434-3556



Excavating & Bulldozing  
Driveways & Foundations  
Gravel/Stone Hauled  
Septics Dug  
- Pumped & Repaired  
Ponds Dug  
10, 12 & 15 Yard Dumpsters

607\*434\*3556  
RANDY & BRENDA'S

For **ALL** Your  
- SPRING CLEANING - DEMOLITION  
- SCRAP METAL



**Randy & Brenda's**  
**607\*434\*3556**

*Give us a call and get your dumpster today!*

# Palmer's

Trucks & Accessories LLC

*Family Owned & Operated!*  
 Knowledgeable and helpful customer service.

Route 12 South, Oxford  
 (former Chenango Truck Location)  
 607-843-2112  
 palmerstrucks@gmail.com

Your One Source For  
**DUMP BOXES,  
 PLOWS,  
 LIFT GATES  
 and  
 PLATFORMS**



Plus... A Full Line Of Truck Accessories  
 To Trick Out Your Ride.

## PEACHEY AND SON RENOVATIONS

Quality Amish Craftmanship



All phases of Interior and Exterior Renovations

- New Construction
- Siding • Roofing • Additions

**FREE ESTIMATES**

Shem Peachey  
 315-983-2315

### RETRACTABLE FABRIC ROOF & LOUVERED PERGOLA® AWNINGS

SUNAIR AWNINGS AND PERGOLAS OFFER ENDLESS POSSIBILITIES AND ARE THE ULTIMATE PROTECTION FOR YOUR PATIO OR DECK.



MOTORIZED ADJUSTABLE PERGOLAS



RETRACTABLE PATIO AWNINGS



ROLL DOWN BUG SCREENS

UP TO **\$250 OFF**

**SUNAIR® OR  
 SUNTUBE® MODEL  
 LATERAL ARM  
 SUNAIR**

With this coupon. Must submit at time of order. Not valid with other offers or previous sales. Offer available on installed lateral arm awnings only purchased at regular price. Expires 7-30-25.

## No Power? No Problem!

**AGP PELLET STOVE**  
 BURNS ALL GRADES OF WOOD PELLETS

*The Most Reliable Pellet Stove on the Planet!*

**NORTH AMERICA'S Favorite Fire**  
**Lopi**

- Easy To Operate
- Easy To Maintain
- Easy To Live With



Don't be left out in the cold this winter. A Fireplace Xtrordinair® or Lopi® hearth appliance can provide your family with warmth & comfort even when the power goes out! P.S. - You can even use your Lopi to cook on! Now is the perfect time to invest in a beautiful Fireplace Xtrordinair® or Lopi® gas or wood heater. Come see our vast selection of fireplaces, inserts and stoves that can add the ambiance of fire to any home. Talk to us about your creative vision of fire and let us help you ignite the fire within.



116 Warn Pond Rd., Rte. 12 South, Oxford  
 607-843-2000

Hours: Mon., Tues., Wed., & Fri. 10 am-5 pm; Thurs. 10 am-6 pm; Saturday 9 am-1 pm

[www.countrysideoxford.com](http://www.countrysideoxford.com)

Follow us on Facebook for Recipes & Specials



**FAMILY OWNED AND OPERATED IN OXFORD SINCE 1989**



**LOOKING FOR A NEW KITCHEN OR BATH...**

**COME TO THE #1 DESIGN CENTER IN CHENANGO COUNTY.**



Our designers have over 50 years of combined experience.

**BUDGET TO CUSTOM, WE CAN HELP!**

Call or stop in today to start your dream kitchen or bath.

Flooring • Windows

• Shower Doors

• Countertops-

Corian, Quartz, Granite & Laminate

**NO INTEREST FINANCING**

available to qualified buyers.

Stop in for details.



**• WINDOWS • DOORS • SIDING • AWNINGS  
• SCREEN & 3 SEASON ROOMS • SHEDS • PERGOLAS**



**• VINYL FENCE • ALUMINUM FENCE • CEDAR FENCE**



**• VINYL RAILING • ALUMINUM RAILING**



**• COMPOSITE DECKING • POLY DECKING**



**• DOCKS • CARPORTS • GARAGES • UTILITY & AGRICULTURE BLDS.**

**116 WARN POND RD., OXFORD - CALL FOR A FREE ESTIMATE 607-843-9834**

Hours: Mon., Tues., Wed., & Fri. 10 am-5 pm; Thurs. 10 am-6 pm; Saturday 9 am-1 pm

**YOUR COMPLETE  
BIG/LITTLE  
HOME CENTER**

**Kitchen Cabinets & Vanities**

- Omega Framed
- Omega Full Access Frameless
- WF Cabinetry
- WF Capital
- JSI Cabinetry
- Cubitac Cabinetry
- Avance Cabinetry
- US Cabinet Framed
- US Cabinet Frameless
- Backwoods Amish Built RTA
- Kitchen Compact
- Amerock Cabinet Hardware
- Wurth Cabinet Hardware
- Richeliu Cabinet Hardware
- Rev-A-Shelf Cabinet Accessories

**Outdoor Kitchens**

- Open Air Outdoor Cabinetry
- Rock Run Aluminum Cabinetry

**Countertops**

- WilsonArt Quartz
- Silestone Quartz
- Hanstone Quartz
- Dekton
- Sensa Granite
- Coran Solid Surface, Quartz & Endura
- Laminate - Custom & Postform
- MSI Quartz

**Vanity Tops**

- Quartz & Granite
- Remee Cultured Marble, Granite, Quartz
- Stone Central Granite or Silestone
- Samuel Mueller Solid Surface
- Swanstone Solid Surface

**Ceramic Tile & Stone**

- Florida Tile - Wall, Floor, Backsplash
- Merola Tile - Wall, Floor, Backsplash
- Lungaro Backsplash & Specialty Tile
- Earthen Treasure Granite, Marble, Stone Tile

**Sheet & LVT Flooring**

- IVC Flexitec
- Tarkett Fiberfloor
- Floamation LVT Glue Down
- Congoleum Triversa LVT Click
- NextFloor StoneCast LVT Click
- NextFloor Scratchmaster LVT Click
- H\*Flor Pikes Peak Click
- H\*Flor PRESTG Artistry Glue Down/Click
- Trillium Cerameta LVT Glue Down
- Generations Lineage LVT Glue Down

**Flooring**

- BSL Hardwood
- Elite Advantage Engineered Hardwood
- Advanced Edge Sports Flooring

**Carpet**

- NRF Select Carpet
- Carpet Tile - Commercial & Residential
- Indoor/Outdoor Carpet
- Foss Carpet Tile
- NEFS Carpet

**Shower & Tub Walls**

- Samuel Mueller Solid Surface
- Swanstone Solid Surface
- Fibo Laminate
- Wedi Tub & Shower Systems
- Certified Wedi Pro Shower System Dealer

**Shower Doors**

- Century Bathworks Shower Doors
- Arizona Shower Door
- Samuel Mueller Shower Doors

**Samuel Mueller Bath Accessories**

- Grab Bars, Shelves, Towel Bars, Hooks,
- Shower Niches/Storage Pods,
- Shower Seats - Fixed & Stand Alone

**Maidstone Claw Foot Tubs, Kitchen & Bath**

- Oak Pointe Stair & Railings Components
- Wood, Metal, Cable

**CycloVac Central Vacuum Cleaners**

**Railings & Porch Posts**

- Superior Plastics Vinyl
- Superior Plastics Cable
- Keylink Aluminum
- Keylink Aluminum Cable
- Eastern Illusions Vinyl Railings
- Eastern Ornamental Aluminum
- Evolve Solid Plastic Railings

**Decking**

- Clubhouse Cellular PVC
- MoistureShield Composite
- Evolve Solid Plastic Lumber & T&G Decking
- Renew Decking & Trim
- Rhino Armadillo Decking
- TruNorth Composite
- Duxxbak Composite Decking
- Aeratis Cellular PVC Porch Flooring
- Siberian Larch Wood Decking
- Western Larch Wood Decking
- Lunawood Thermowood Decking
- Tropical Hardwood Decking
- Southern Yellow Pine Porch Flooring
- Western Red Cedar Boards, Decking, Siding
- Trimax Plastics Structural Plastic Lumber
- ZipUP Underdeck Ceiling Panels

**Fencing**

- Superior Plastics Vinyl
- Keylink Aluminum
- Masterlink Chain-link
- Eastern Illusions Vinyl Fence
- Eastern Ornamental Aluminum
- Eastern Cedar

**Siding**

- Royal Vinyl Siding
- Foundry Vinyl Shakes & Siding
- MidAmerica Shutters & Siding Accessories
- Koma Cellular PVC Boards & Trim
- Metal Sales Steel Roofing & Wall Panels

**Awnings - Retractable, Window,**

- Door Pergolas, Sun Shades, Canopies
- Aristocrat Awnings
- Sunair Awnings
- Agecraft Aluminum Awnings

**Screen & 3 Season Rooms**

- Ballew's Aluminum Screen Rooms
- Ballew's Alum. Carport & Patio Covers
- Ballew's Mobile Home Roof Overs
- Ballew's Aluminum & Vinyl 3 Season Rms
- Aristocrat Aluminum & Vinyl 3 Season Rms

**Outdoor Patio & Stone Veneers**

- Adorn Firepits, Planters & Pavers
- Genstone Veneer Panels
- Adorn Mortarless Stone Panels
- Interceramic Ledger Stone
- Slimstone Stone Veneer Sheets

**Boat Docks**

- Tommy Docks & Accessories
- Techstar Dock Floats
- Dockmaster Boat Ramps
- DockEdge Dock Components & Accessories
- American Muscle Dock Components & Accessories

**Doors & Windows**

- NC Fiberglass & Steel Entrance Doors
- Wood & Molded Prehung Interior Doors
- Woodgrain Interior & Exterior Wood Doors
- National Vinyl Sliding Doors
- Larson Storm Doors
- National Vinyl Replacement Windows
- National Vinyl New Construction Windows

**American Steel Carports, Garages, Ag Blds**

**Catskill Sheds & Garages**

## Your Vision, Our Craftsmanship!

From concept to completion, we bring your dream space to life with:

- Expert in-house installation- no subcontractors
  - Custom designs tailored to your style
  - A fully stocked retail showroom for all your tile & marble needs

*Your locally owned and operated  
Kitchen & Bath Design Center*



### Nappi Tile and Marble



*Come in and visit us today!*



**NappiTileandMarble.com**

10700 Rte. 23, Suite 2, Davenport Center  
607-278-6411

# Soak up these luxurious bathroom features

Kitchens and bathrooms are two popular areas to address when renovating a home. Modernize Home Services says 26 percent of sellers make bathroom improvements to their homes before listing. Midscale bath remodels will net a return on investment of about 64 percent, while a luxury bathroom overhaul has an ROI of about 57 percent.

When considering bathroom renovations, homeowners may want to include some unique features that can add style and function, not to mention some much-deserved luxury. With that in mind, the following are some luxurious features to consider.

- **Heated floors:** There is something to be said for stepping out of the shower and being met with warmth underfoot. Heated floors are not just for people who live in cold climates, either. When the air conditioning is pumping on hot days, tile floors can feel chilly. Heated floors also are aesthetically appealing because homeowners don't have to factor in baseboard heaters or forced-air vents.
- **Steam showers:** There are many different steam showers on the market, and each can turn regular showers into steamy spa-like enclaves. A steam shower is similar to a sauna and utilizes a steam generator to produce steam in a single area, advises Badeloft® Luxury Bathrooms.
- **Soaking tub:** Although the majority of people shower as part of their daily hygiene routine, a deep soaking tub separate from the shower is ideal for those who enjoy a good bath.
- **Luxury mirror:** Upgrading the bathroom mirror to one that offers features like defoggers, integrated lighting and a dimmer setting can elevate the bathroom.



## COMFORT°

Achieve a whole new degree of comfort with  
LG Air Conditioning Technologies

- Personalized room-by-room control keeps everyone happy
- Control from anywhere via LG SmartThinQ® app on a smartphone
- Ducted and non-ducted systems offer broad design flexibility
- Industry-leading energy efficiency and superior heating

Discover why homeowners who choose LG Air Conditioning Technologies enjoy greater comfort.



Contact your local LG representative  
for more information:  
607-336-5572

6053 Co. Rd. 32, Norwich, NY 13815  
brothers@centralny.twcbc.com

**AVOLIO**  
— **BROTHERS, LLC** —  
Plumbing • Heating • Air Conditioning





- **Floating vanity:** A floating vanity is mounted directly to the wall to leave space underneath. Better Homes & Gardens says a floating vanity can lend an airy feel to a bathroom.
  - **Frameless shower:** A frameless (glass) shower door is not only luxurious but also functional for people who want to age in place. With no edge or lip to step over to enter the shower, anyone with mobility challenges can walk into a frameless shower safely.
  - **Water closet:** If space allows, separating the toilet in a water closet from the rest of the bathroom space affords even more privacy. Plus, in couple's bathrooms, a water closet enables two to use the bathroom at the same time for different functions.
  - **Walk-in-closet:** Relocating the bedroom closet to right off the owner's bathroom affords an immediate opportunity to dress comfortably, thus streamlining a morning routine.
- Bathroom renovations are worthwhile investments. Choosing some unique upgrades can enhance the design and function of these important spaces. HI254747



**FINANCING AVAILABLE ON YOUR ENTIRE PURCHASE**



**NORWICH OUTDOOR POWER EQUIPMENT**

5876 County Rd. 32- East River Road, Norwich  
607-334-4378 • [www.norwichope.com](http://www.norwichope.com)

Hours:  
8:00-5:00 Monday-Friday  
and  
8:00-12:00 on Saturday

*"We Gotcha Covered!"*



## WEBSTER'S PAVING

- Blacktop
- Stone & Oil
- Sealing
- Patching

COMMERCIAL  
& RESIDENTIAL

(607) 432-8550  
(607) 334-4849



**GILBERT PLUMBING  
& HEATING**

## Plumbing & Heating Specialists



We offer full heating equipment service including new installations, repairs and service contracts.

Gilbert Plumbing and Heating has been providing quality plumbing and heating services for over 30 years.



We provide commercial and residential services for any heating or plumbing system installation and repairs.

Contact us for details or for an estimate.

**Gilbert Plumbing and Heating...Quality without Compromise!**



**Buderus**



**ThermoPride**

**24/7 EMERGENCY SERVICE**

PO Box 96, Gilbertsville, NY 13776  
[www.gilbertph.com](http://www.gilbertph.com)

607-783-2289



# Steel Sales Inc.



**OPEN TO THE PUBLIC!**

P.O. Box 539, 8085 State Hwy. 12  
Sherburne, NY 13460

**WE SELL**

## Metal Roofing & Siding



### Your Source for Steel, Stainless, Aluminum & More

Structural Shapes & Bars



Sheet & Plate Products



Concrete Reinforcing Products



Piles Decks & Grates



Additional Building Materials



Tube & Piping



Drainage Products



Snow Plow & Heavy Equipment Wear Parts



### Custom Fabrication

350 Ton Press Brake



High Definition Plasma Table



OMAX Water Jet



Monarch Vertical Milling Machine



Plate Roller



Cincinnati Hydraulic Shear



**800-238-7833 or 607-674-6363**

**Fax: 607-674-9706**

**www.SteelSalesInc.com**



# Our Customers Are Our First Priority

## Our Pledge...

Our Customers are our first priority. Reese-Marshall is here to serve you with your heating and cooling needs. We Pledge to constantly reaffirm this with our actions, which we have built our reputation on.

## We Offer...

- Free estimates for all installations
- Automatic delivery with a guarantee
- 24-hour emergency service, 365 days a year
- A variety of budget and burner service plans
- People who care about providing quality service

## Our Area of Service...

Reese-Marshall Co. Inc.'s office and storage facility is located on County Road 32, in Norwich. Our service area extends to Norwich and the following areas:

- Oxford - McDonough - Guilford - Preston
- Mt. Upton - Gilbertsville - Morris
- South New Berlin - New Berlin - Edmeston
- South Edmeston - West Edmeston - Pittsfield
- Sherburne - North Norwich - Earlville - Columbus Smyrna
- Otselic - South Otselic - Pitcher - Plymouth
- Sidney - Bainbridge
- Hamilton - Madison - Morrisville - Brookfield

## Quality Products...

Reese-Marshall Co. Inc. carries a full line of quality fuels including B-10 Heating Oil, Diesel, Gasoline and Propane Gas.

Our Burner Service Department is fully equipped to handle any repair or installation.



## Safe Quality Heating Systems

**Thermo Pride**

**Buderus**

**Rinnai**

**Thinking of a new heating system?  
Don't hesitate to call for a free written estimate.**



**REESE-MARSHALL**

*We make warm friends and keep you cool.*  
since 1942

6254 County Road 32, Norwich, NY 13815

**PHONE (607) 334-3633**

www.reesemarshall.com • Email: info@reesemarshall.com

Opening  
Friday, April 25th!

# Gretna Gardens

(formerly Otsdawa Greenhouse)

Beautiful hanging baskets,  
impatiens, geraniums & more!

Stop and See  
All We Have For **You!**

## Gretna Gardens

*"We Make Your Day Beautiful"*

2664 State Highway 7 • Otego, NY 

**607-267-1707**

Hours: Mon.-Sat. 9 am - 6 pm; Sun. 9 am - 5 pm

# Do you need a home NOW?



## HOMES AVAILABLE NOW!

Stop in and let one of our knowledgeable salespeople help you find your dream home.

Call for more information  
**315-858-2100**

**Better Homes**  
& Transport, Inc.  
Your Affordable Housing Solution

3787 US Hwy 20,  
Richfield Springs, NY 13439  
Hours: Mon.-Fri. 9-5; Sat. 11-3; Closed Sun.  
See our website for other  
GREAT Homes on Display:  
[www.betterhomesandtransport.com](http://www.betterhomesandtransport.com)



# BUILDING YOUR DREAM HOME JUST GOT MORE AFFORDABLE

## Start Your Build. Just Pay Interest.

Make interest-only payments as stages of your home are being completed, plus you can manage your loan online for faster funding and real-time updates. **Now, let's start building together!**



Construction loans made easy.  
Scan to see how NBT Bank can get you moving!

**NBT BANK**  
*It starts here*

Get started today at [www.nbtbank.com/construction](http://www.nbtbank.com/construction)